

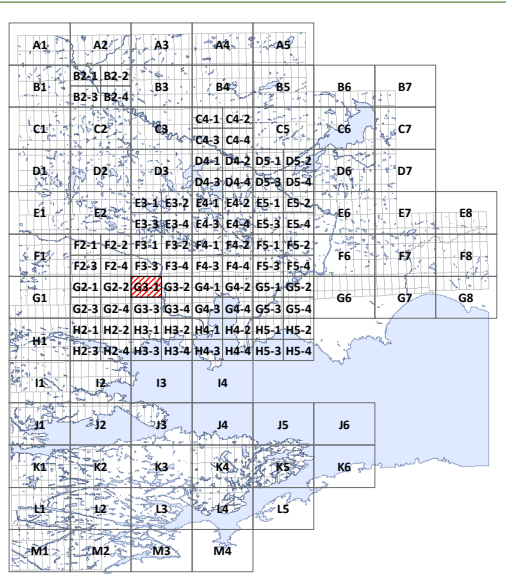

# WEST NIPISSING OUEST ZONING BY-LAW 2014-45

CONSOLIDATION  
JUNE 1, 2018

# Schedule G3-1 CALDWELL

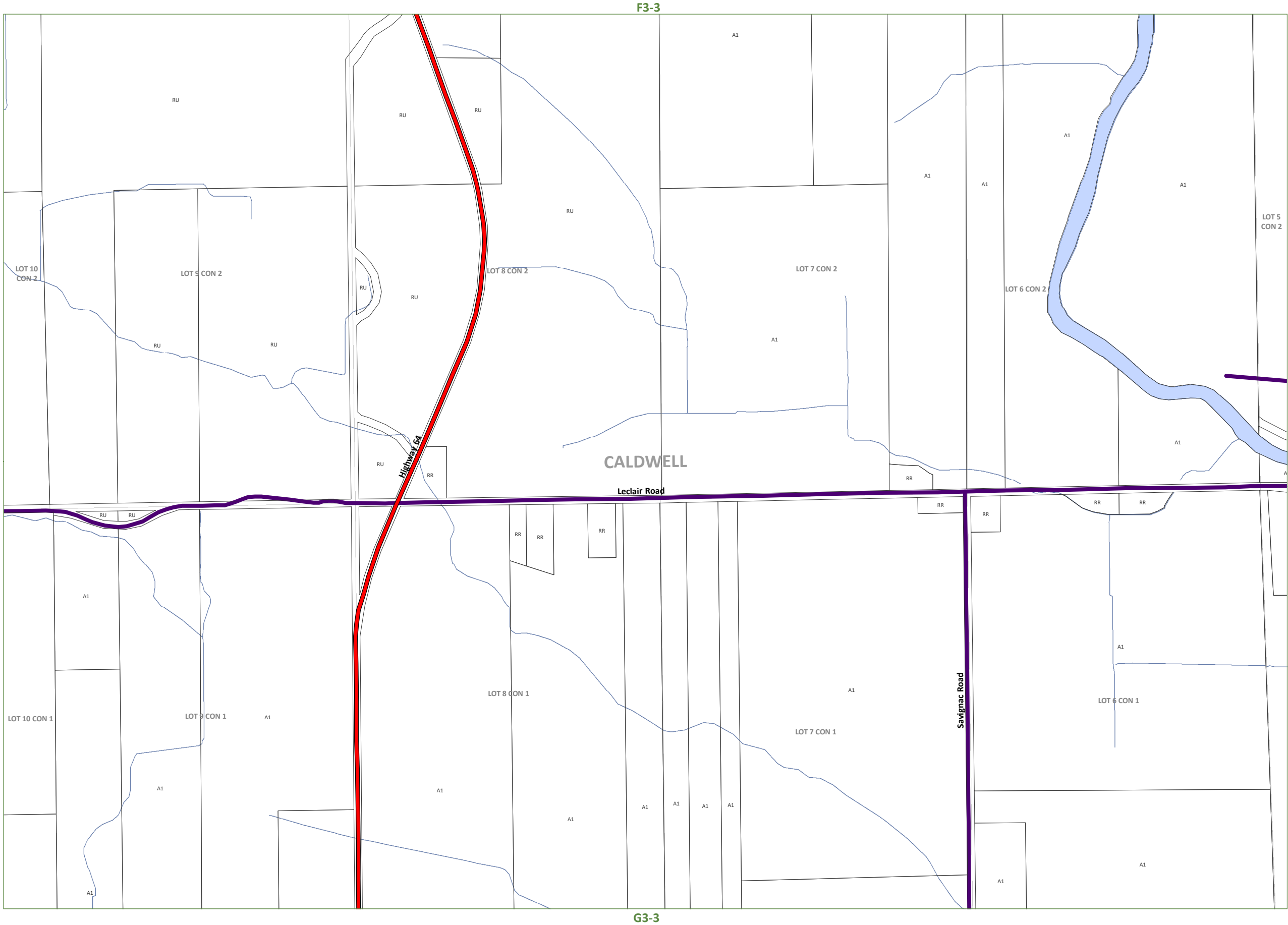

A1	Agriculture One	RU	Rural
A2	Agriculture Two		
R1	Residential One	R2	Residential Two
R3	Residential Three	R4	Residential Four
SR	Shoreline Residential		
RR	Rural Residential		
MHR	Mobile Home Residential		
C1	General Commercial	C2	Highway Commercial
C3	Tourist Commercial		
M1	Light Industrial	M2	Heavy Industrial
M3	Extractive Industrial		Waste Disposal Industrial
CL	Crown Land	OS	Open Space
CF	Community Facility		
PSW	Provincially Significant Wetland		
HZ	Hazard Lands		
	Waste Management Influence Area		
	Settlement Areas		
	Former Municipal Boundaries		
	Highways		Private Roads
	Township Roads		Resource Roads
	Pipeline		Rail Lines

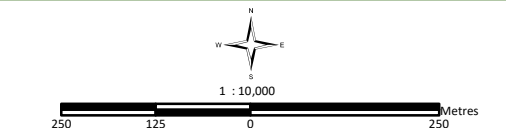

This map is for illustration purposes only. The information displayed on this map has been created from Ministry of Natural Resources, Ontario Base Mapping & MPAC Property Fabrics. While every effort has been made to accurately depict the information, this map should not be relied on as a precise indicator of locations of features or roads.

Base Mapping Source:  
Ministry of Natural Resources - Ontario Base Mapping  
MPAC - Municipal Property Assessment Corporation



WEST NIPISSING OUEST  
ZONING BY-LAW 2014-45

CONSOLIDATION  
JUNE 1, 2018

Schedule G3-2  
CALDWELL

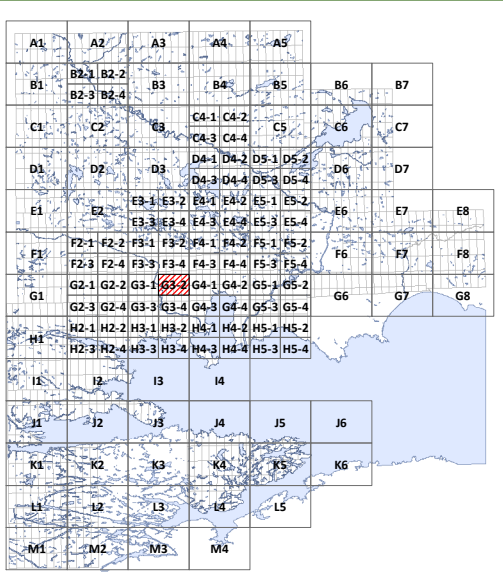
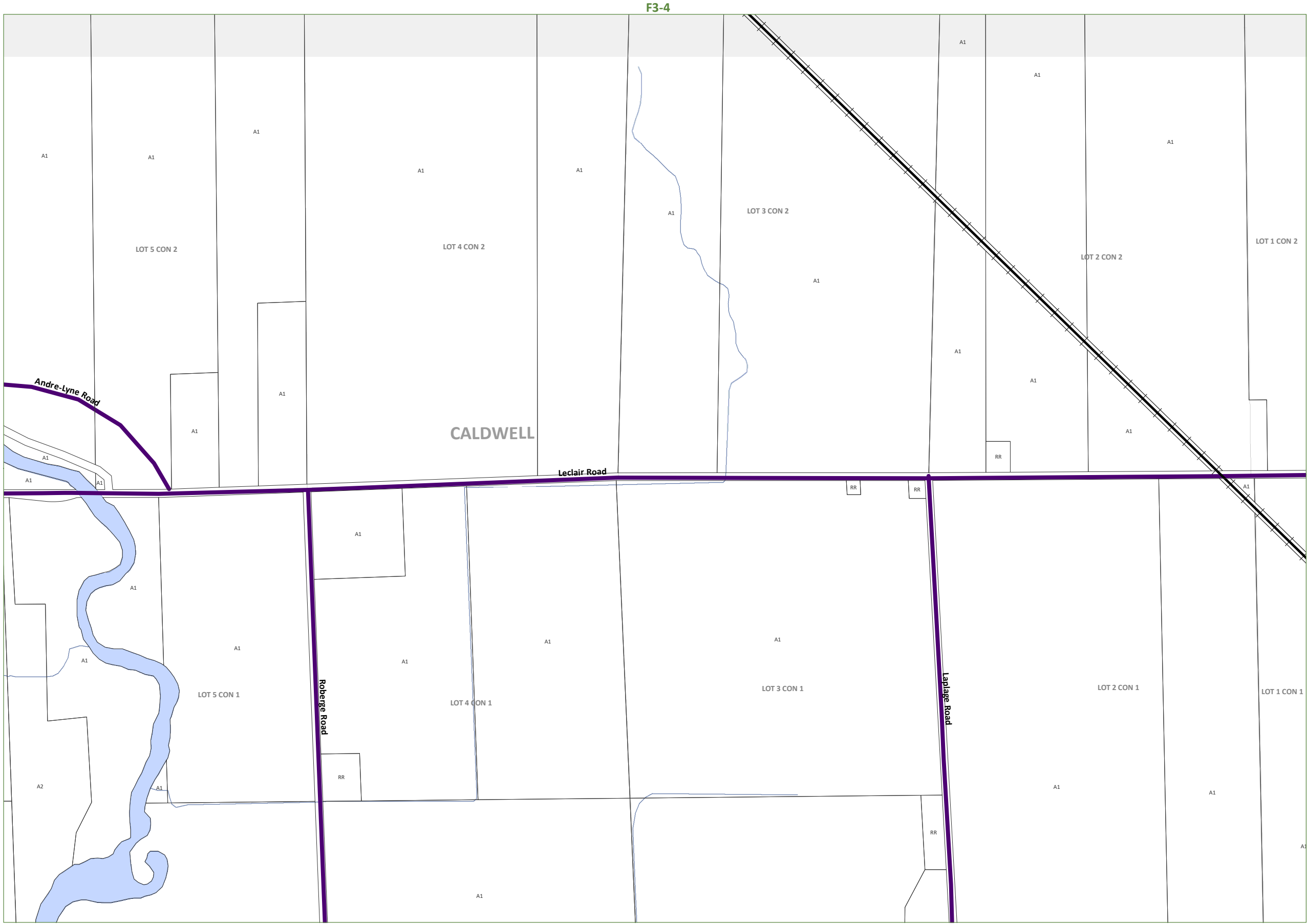

A1	Agriculture One	RU	Rural
A2	Agriculture Two		
R1	Residential One	R2	Residential Two
R3	Residential Three	R4	Residential Four
SR	Shoreline Residential		
RR	Rural Residential		
MHR	Mobile Home Residential		
C1	General Commercial	C2	Highway Commercial
C3	Tourist Commercial		
M1	Light Industrial	M2	Heavy Industrial
M3	Extractive Industrial		Waste Disposal Industrial
CL	Crown Land	OS	Open Space
CF	Community Facility		
PSW	Provincially Significant Wetland		
HZ	Hazard Lands		
	Waste Management Influence Area		
	Settlement Areas		
	Former Municipal Boundaries		
	Highways		Private Roads
	Township Roads		Resource Roads
	Pipeline		Rail Lines

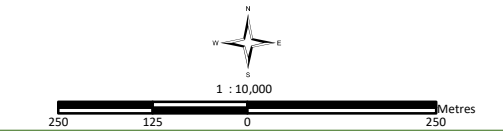

This map is for illustration purposes only. The information displayed on this map has been created from Ministry of Natural Resources, Ontario Base Mapping & MPAC Property Fabrics. While every effort has been made to accurately depict the information, this map should not be relied on as a precise indicator of locations of features or roads.

Base Mapping Source:  
Ministry of Natural Resources - Ontario Base Mapping  
MPAC - Municipal Property Assessment Corporation



WEST NIPISSING OUEST  
ZONING BY-LAW 2014-45

CONSOLIDATION  
JUNE 1, 2018

Schedule G4-1  
CALDWELL/SPRINGER

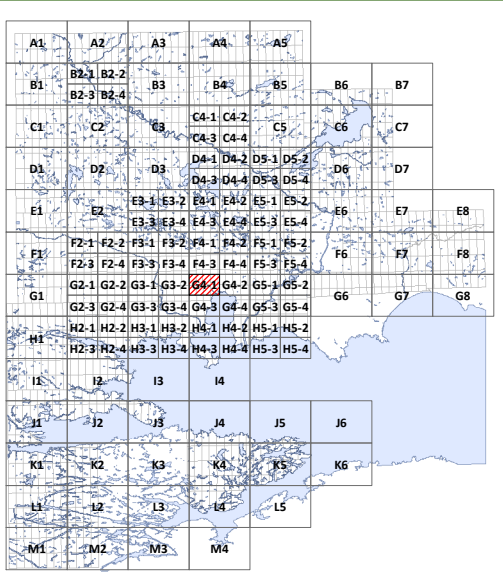
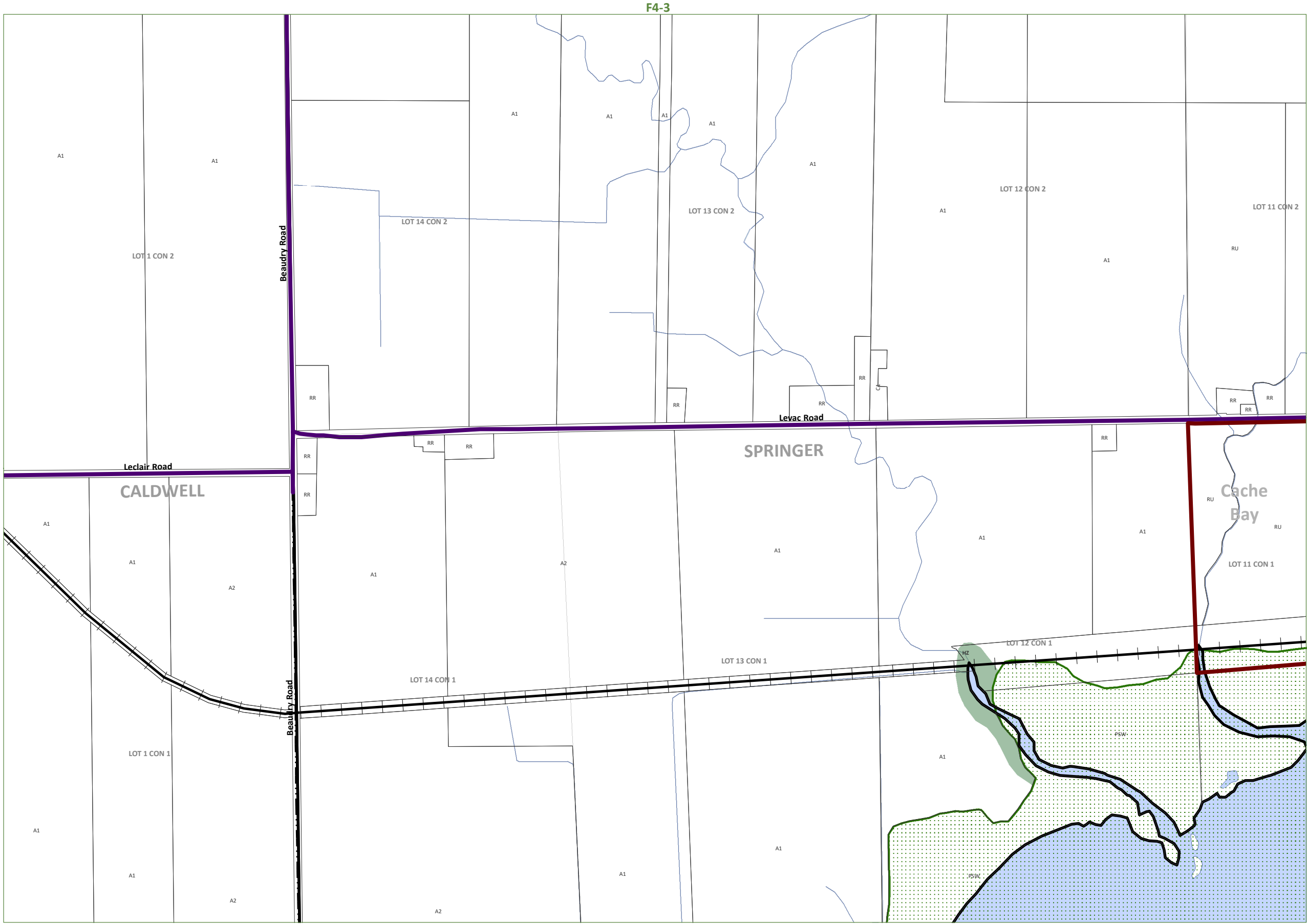

A1	Agriculture One	RU	Rural
A2	Agriculture Two		
R1	Residential One	R2	Residential Two
R3	Residential Three	R4	Residential Four
SR	Shoreline Residential		
RR	Rural Residential		
MHR	Mobile Home Residential		
C1	General Commercial	C2	Highway Commercial
C3	Tourist Commercial		
M1	Light Industrial	M2	Heavy Industrial
M3	Extractive Industrial		Waste Disposal Industrial
CL	Crown Land	OS	Open Space
CF	Community Facility		
PSW	Provincially Significant Wetland		
HZ	Hazard Lands		
	Waste Management Influence Area		
	Settlement Areas		
	Former Municipal Boundaries		
	Highways		Private Roads
	Township Roads		Resource Roads
	Pipeline		Rail Lines

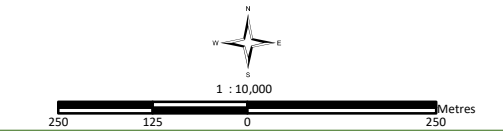

This map is for illustration purposes only. The information displayed on this map has been created from Ministry of Natural Resources, Ontario Base Mapping & MPAC Property Fabrics. While every effort has been made to accurately depict the information, this map should not be relied on as a precise indicator of locations of features or roads.

Base Mapping Source:  
Ministry of Natural Resources - Ontario Base Mapping  
MPAC - Municipal Property Assessment Corporation



# WEST NIPISSING OUEST

## ZONING BY-LAW 2014-45

CONSOLIDATION  
JUNE 1, 2018

# Schedule G4-2

SPRINGER

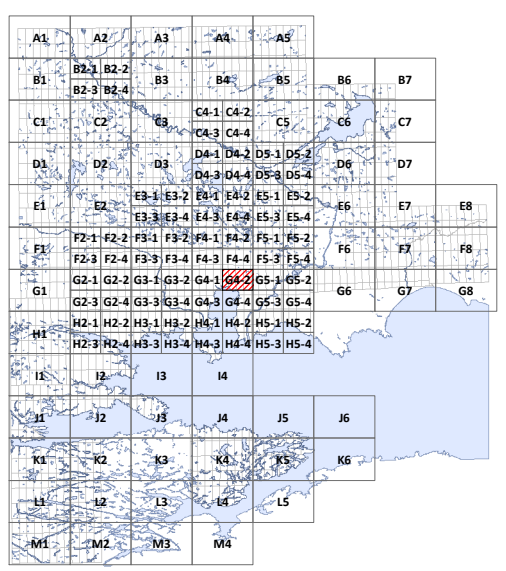
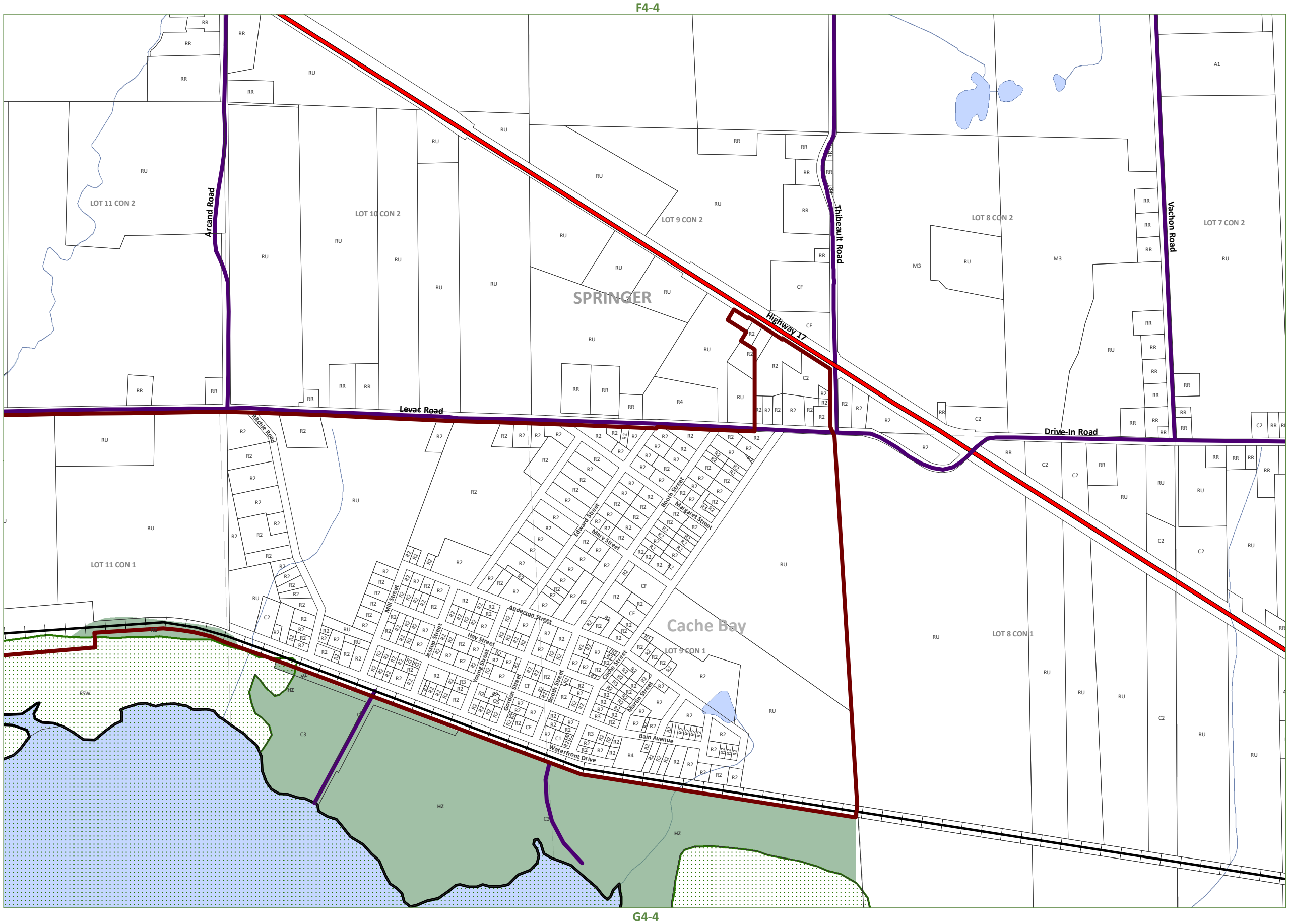

- |                                      |                           |
|--------------------------------------|---------------------------|
| A1 Agriculture One                   | RU Rural                  |
| A2 Agriculture Two                   |                           |
| R1 Residential One                   | R2 Residential Two        |
| R3 Residential Three                 | R4 Residential Four       |
| SR Shoreline Residential             |                           |
| RR Rural Residential                 |                           |
| MHR Mobile Home Residential          |                           |
| C1 General Commercial                | C2 Highway Commercial     |
| C3 Tourist Commercial                |                           |
| M1 Light Industrial                  | M2 Heavy Industrial       |
| M3 Extractive Industrial             | Waste Disposal Industrial |
| CL Crown Land                        | OS Open Space             |
| CF Community Facility                |                           |
| PSW Provincially Significant Wetland |                           |
| HZ Hazard Lands                      |                           |
| WMA Waste Management Influence Area  |                           |
| SA Settlement Areas                  |                           |
| FMB Former Municipal Boundaries      |                           |
| Highways                             | Private Roads             |
| Township Roads                       | Resource Roads            |
| Pipeline                             | Rail Lines                |

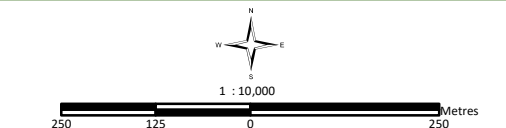

This map is for illustration purposes only. The information displayed on this map has been created from Ministry of Natural Resources, Ontario Base Mapping & MPAC Property Fabrics. While every effort has been made to accurately depict the information, this map should not be relied on as a precise indicator of locations of features or roads.

Base Mapping Source:  
Ministry of Natural Resources - Ontario Base Mapping  
MPAC - Municipal Property Assessment Corporation





# CONSOLIDATION

## JUNE 1, 2018

# Schedule G5-1

SPRINGER

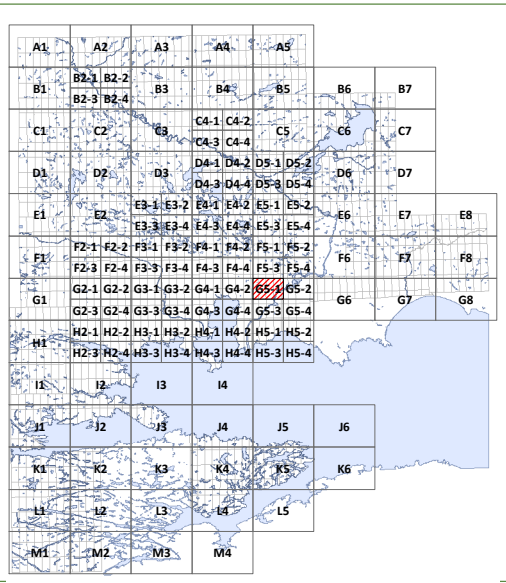

A1	Agriculture One	RU	Rural
A2	Agriculture Two		
R1	Residential One	R2	Residential Two
R3	Residential Three	R4	Residential Four
SR	Shoreline Residential		
RR	Rural Residential		
MHR	Mobile Home Residential		
C1	General Commercial	C2	Highway Commercial
C3	Tourist Commercial		
M1	Light Industrial	M2	Heavy Industrial
M3	Extractive Industrial		Waste Disposal Industrial
CL	Crown Land	OS	Open Space
CF	Community Facility		
PSW	Provincially Significant Wetland		

 Hazard Lands  
 Waste Management Influence Area  
 Settlement Areas  
 Former Municipal Boundaries

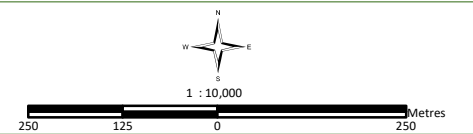

This map is for illustration purposes only. The information displayed on this map has been created from Ministry of Natural Resources, Ontario Base Mapping & MPAC Property Fabrics. While every effort has been made to accurately depict the information, this map should not be relied on as a precise indicator of locations of features or roads.

Base Mapping Source:  
Ministry of Natural Resources - Ontario Base Mapping  
MPAC - Municipal Property Assessment Corporation



**Adopted July 8, 2014**

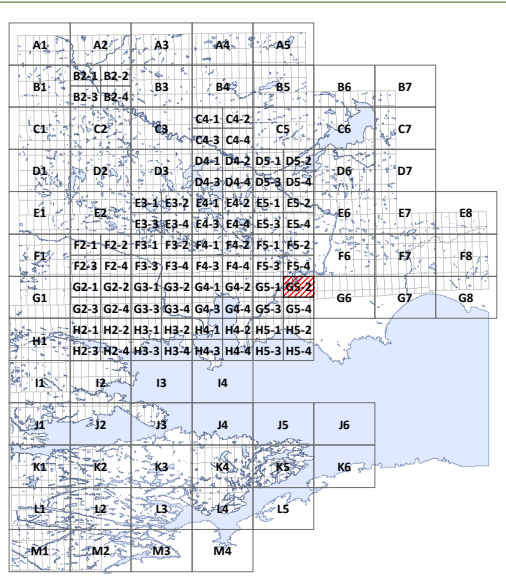
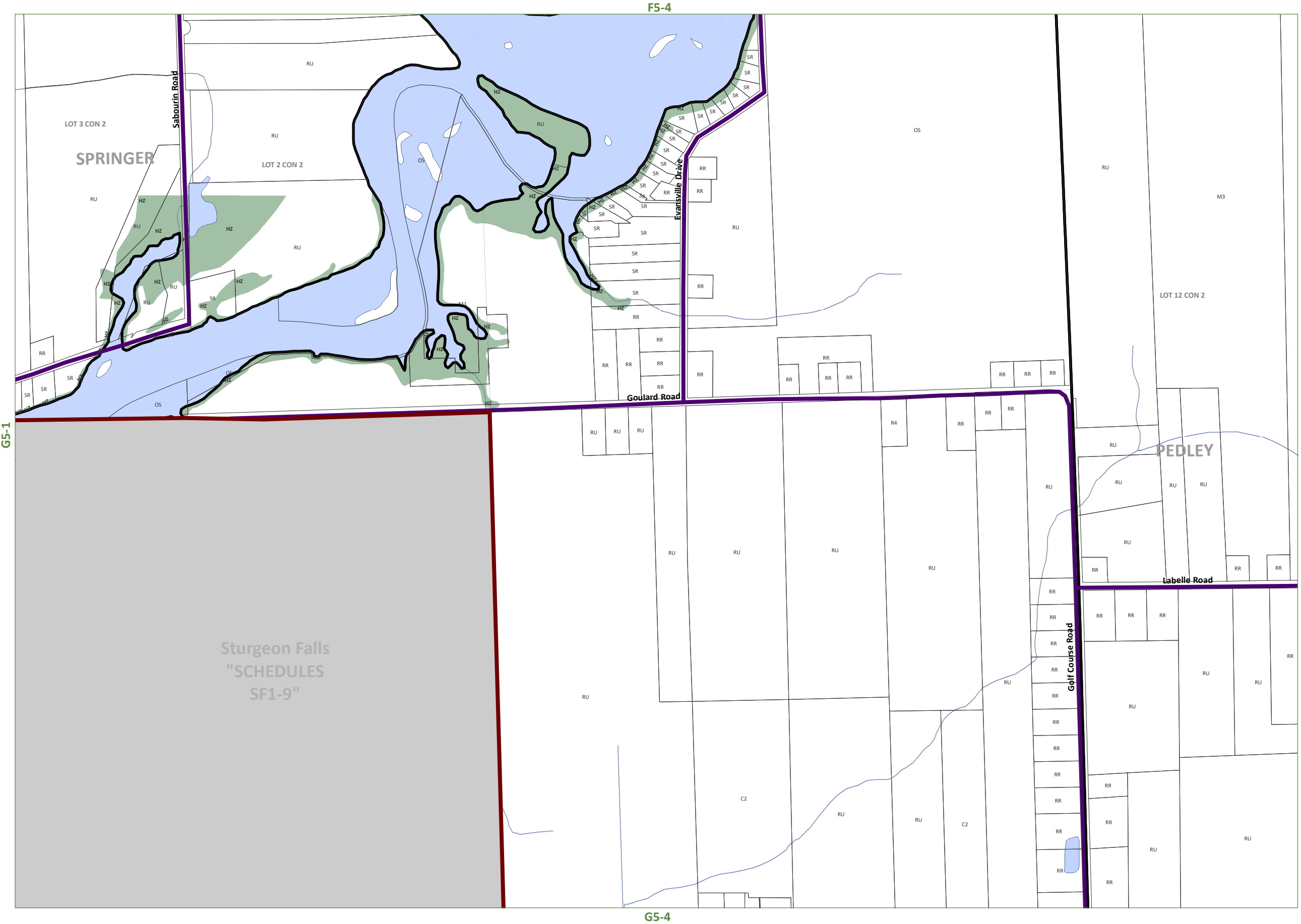

A1	Agriculture One	RU	Rural
A2	Agriculture Two		
R1	Residential One	R2	Residential Two
R3	Residential Three	R4	Residential Four
SR	Shoreline Residential		
RR	Rural Residential		
MHR	Mobile Home Residential		
C1	General Commercial	C2	Highway Commercial
C3	Tourist Commercial		
M1	Light Industrial	M2	Heavy Industrial
M3	Extractive Industrial		Waste Disposal Industrial
CL	Crown Land	OS	Open Space
CF	Community Facility		
PSW	Provincially Significant Wetland		
HZ	Hazard Lands		
	Waste Management Influence Area		
	Settlement Areas		
	Former Municipal Boundaries		
	Highways		Private Roads
	Township Roads		Resource Roads
	Pipeline		Rail Lines

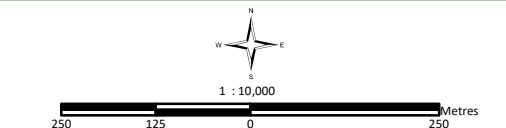

This map is for illustration purposes only. The information displayed on this map has been created from Ministry of Natural Resources, Ontario Base Mapping & MPAC Property Fabrics. While every effort has been made to accurately depict the information, this map should not be relied on as a precise indicator of locations of features or roads.

Base Mapping Source:  
Ministry of Natural Resources - Ontario Base Mapping  
MPAC - Municipal Property Assessment Corporation



# WEST NIPISSING OUEST ZONING BY-LAW 2014-45

CONSOLIDATION  
JUNE 1, 2018

# Schedule G2-3

KIRKPATRICK/MACHPERSON

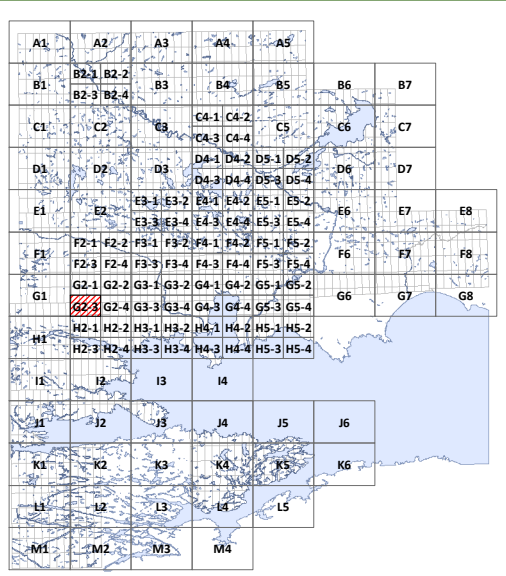
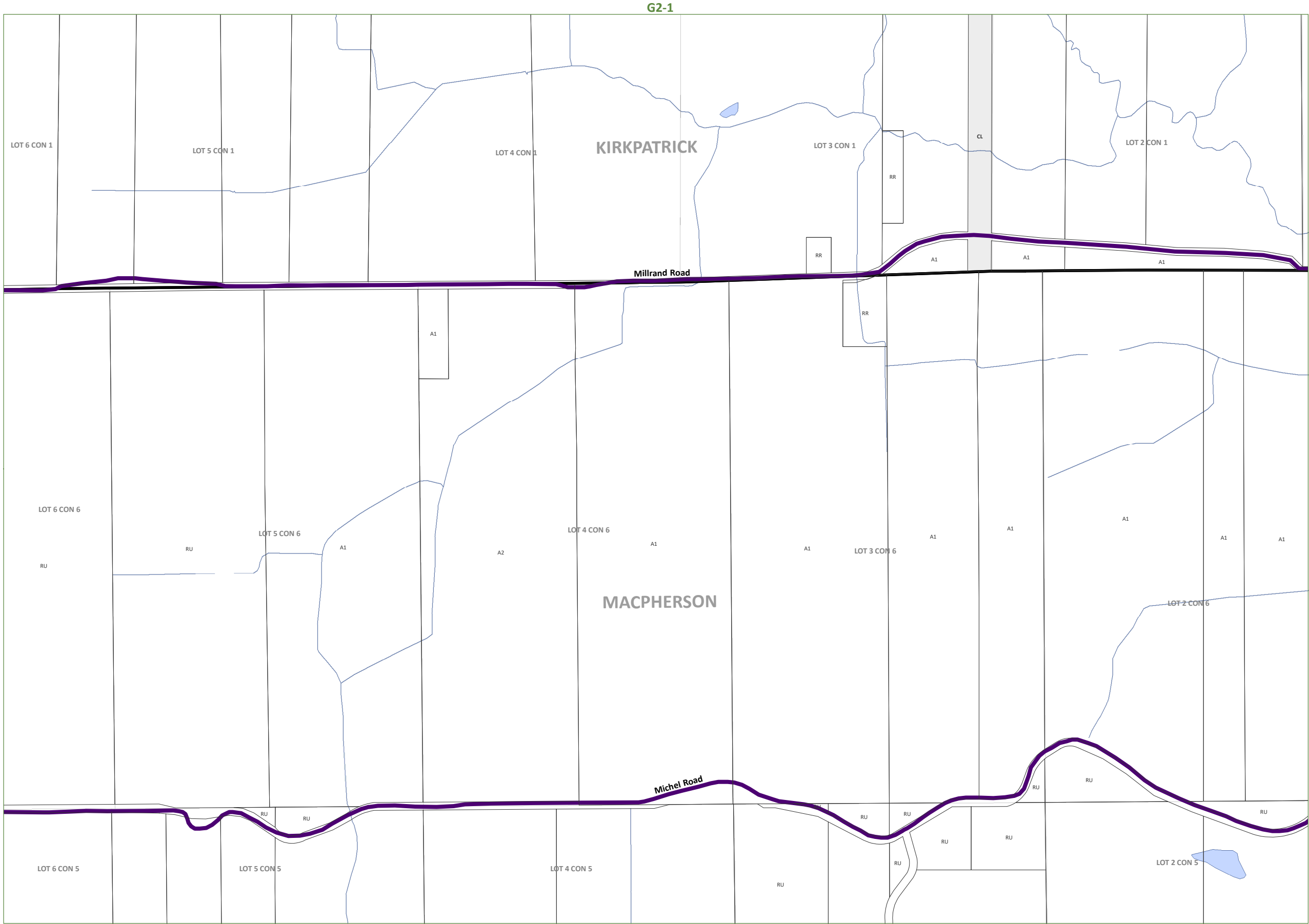

A1	Agriculture One	RU	Rural
A2	Agriculture Two		
R1	Residential One	R2	Residential Two
R3	Residential Three	R4	Residential Four
SR	Shoreline Residential		
RR	Rural Residential		
MHR	Mobile Home Residential		
C1	General Commercial	C2	Highway Commercial
C3	Tourist Commercial		
M1	Light Industrial	M2	Heavy Industrial
M3	Extractive Industrial		Waste Disposal Industrial
CL	Crown Land	OS	Open Space
CF	Community Facility		
PSW	Provincially Significant Wetland		
	HZ	Hazard Lands	
		Waste Management Influence Area	
		Settlement Areas	
		Former Municipal Boundaries	
	Highways	Private Roads	
	Township Roads	Resource Roads	
	Pipeline	Rail Lines	

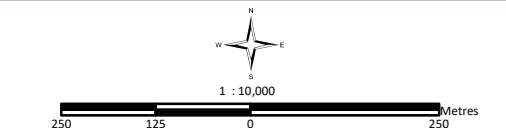

This map is for illustration purposes only. The information displayed on this map has been created from Ministry of Natural Resources, Ontario Base Mapping & MPAC Property Fabrics. While every effort has been made to accurately depict the information, this map should not be relied on as a precise indicator of locations of features or roads.

Base Mapping Source:  
Ministry of Natural Resources - Ontario Base Mapping  
MPAC - Municipal Property Assessment Corporation



# CONSOLIDATION

## JUNE 1, 2018

# Schedule G2-4

**KIRKPATRICK/CALDWELL/MACHPERSON**

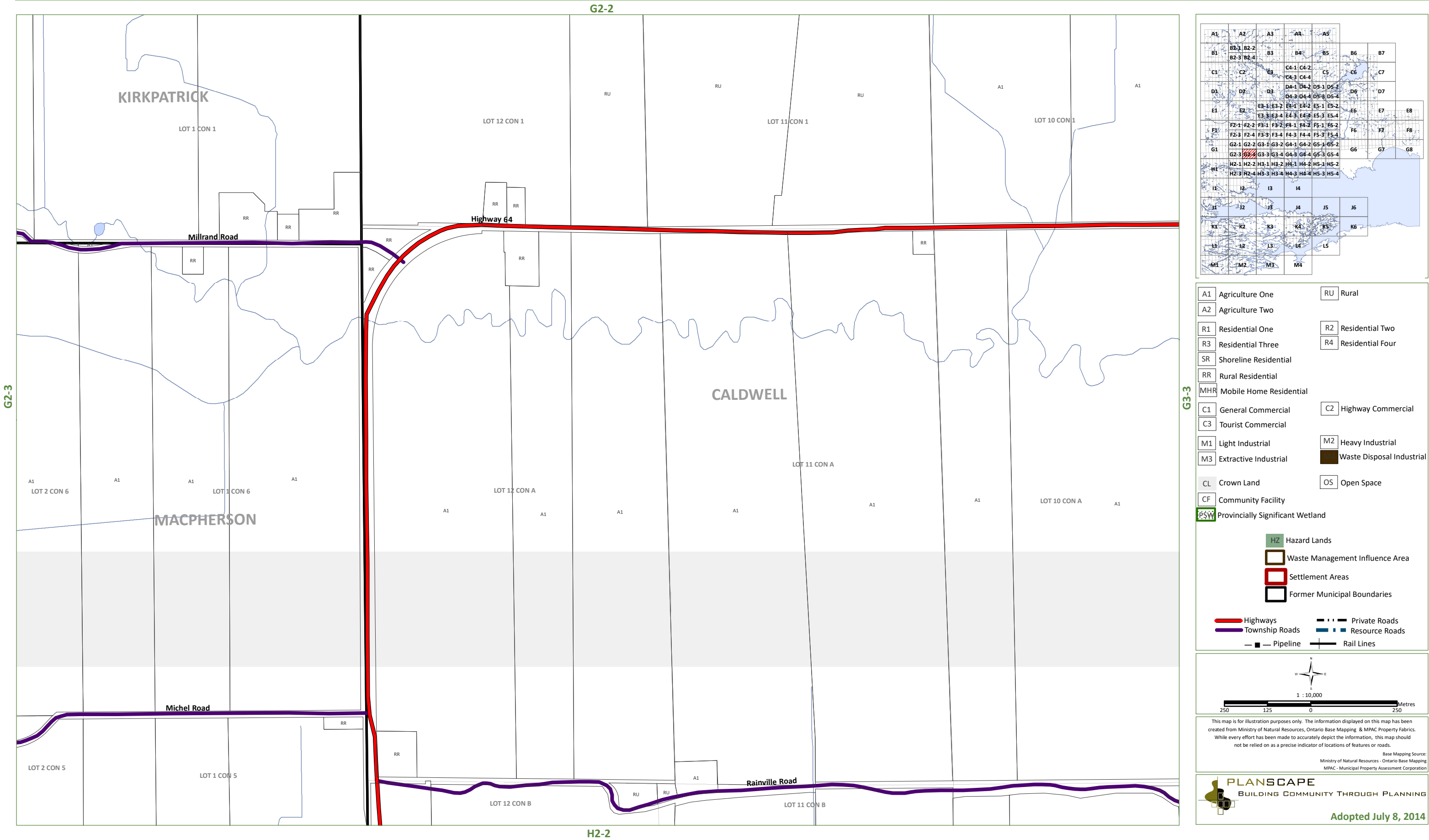





# CONSOLIDATION

## JUNE 1, 2018

# Schedule G3-3

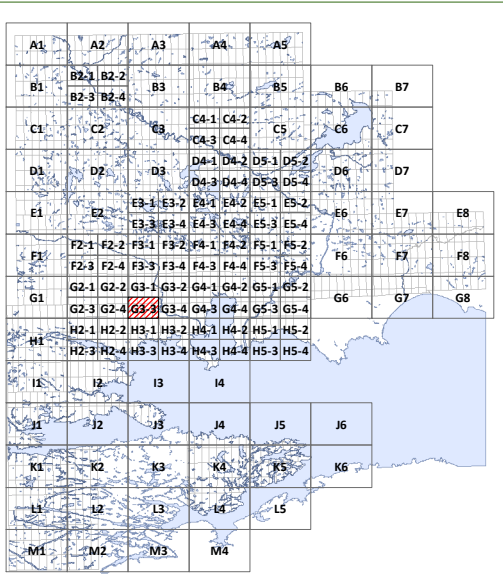
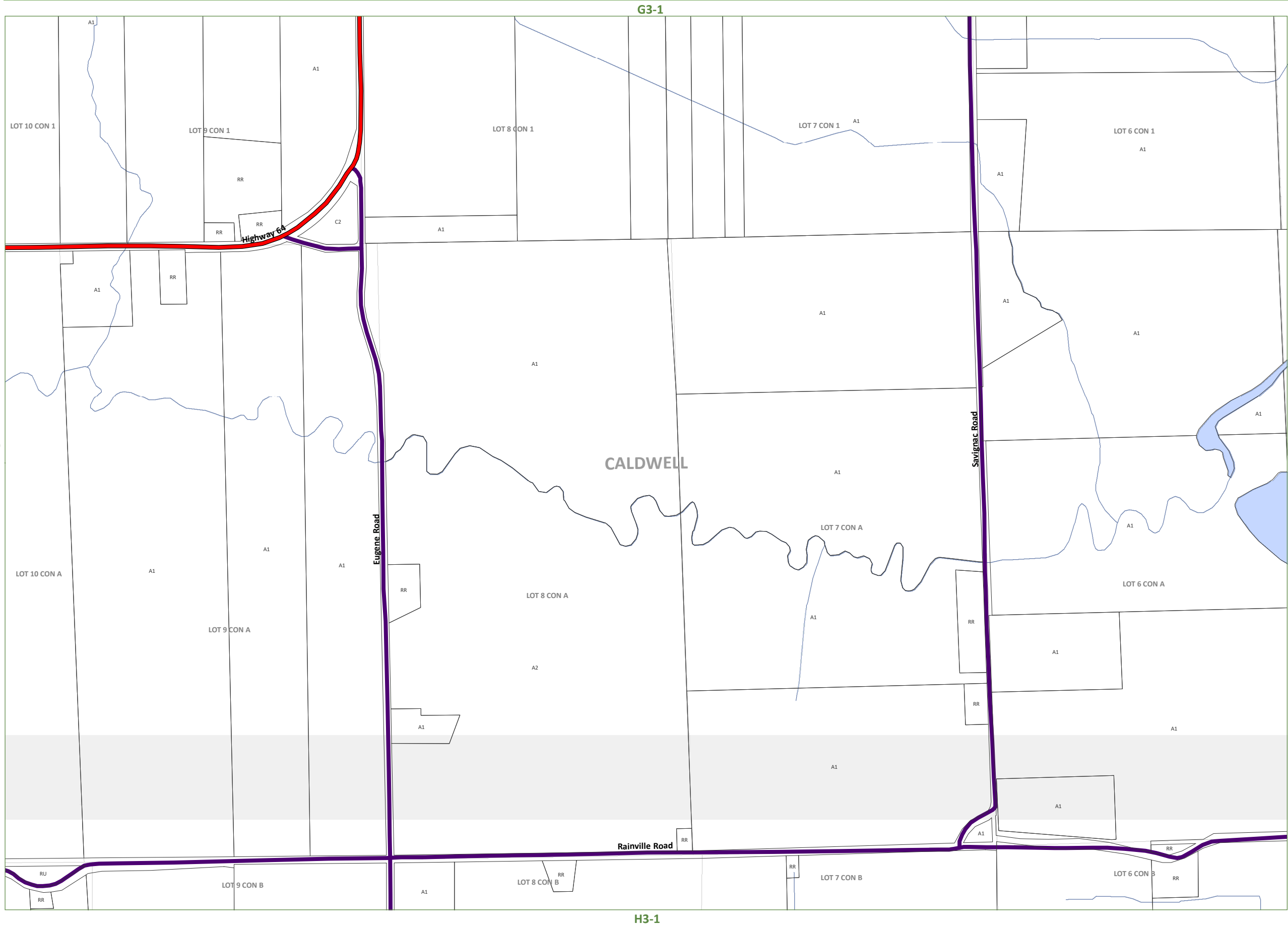
**CALDWELL**

A1	Agriculture One	RU	Rural
A2	Agriculture Two		
R1	Residential One	R2	Residential Two
R3	Residential Three	R4	Residential Four
SR	Shoreline Residential		
RR	Rural Residential		
MHR	Mobile Home Residential		
C1	General Commercial	C2	Highway Commercial
C3	Tourist Commercial		
M1	Light Industrial	M2	Heavy Industrial
M3	Extractive Industrial		Waste Disposal Industrial
CL	Crown Land	OS	Open Space
CF	Community Facility		
PSW	Provincially Significant Wetland		

 HZ Hazard Lands  
 Waste Management Influence Area  
 Settlement Areas  
 Former Municipal Boundaries

 Highways       Private Roads  
 Township Roads       Resource Roads  
 Pipeline       Rail Lines

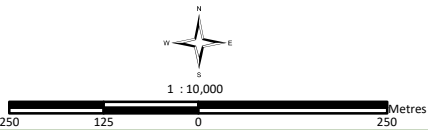

This map is for illustration purposes only. The information displayed on this map has been created from Ministry of Natural Resources, Ontario Base Mapping & MPAC Property Fabrics. While every effort has been made to accurately depict the information, this map should not be relied on as a precise indicator of locations of features or roads.

Base Mapping Source:  
Ministry of Natural Resources - Ontario Base Mapping  
MPAC - Municipal Property Assessment Corporation



**Adopted July 8, 2014**



# WEST NIPISSING OUEST

## ZONING BY-LAW 2014-45

CONSOLIDATION  
JUNE 1, 2018

# Schedule G3-4

CALDWELL

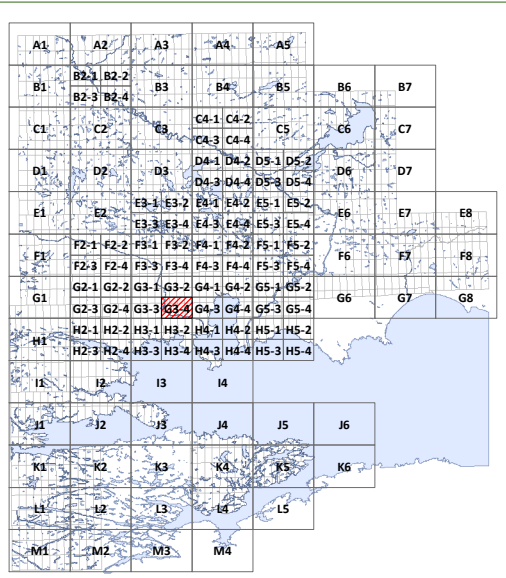
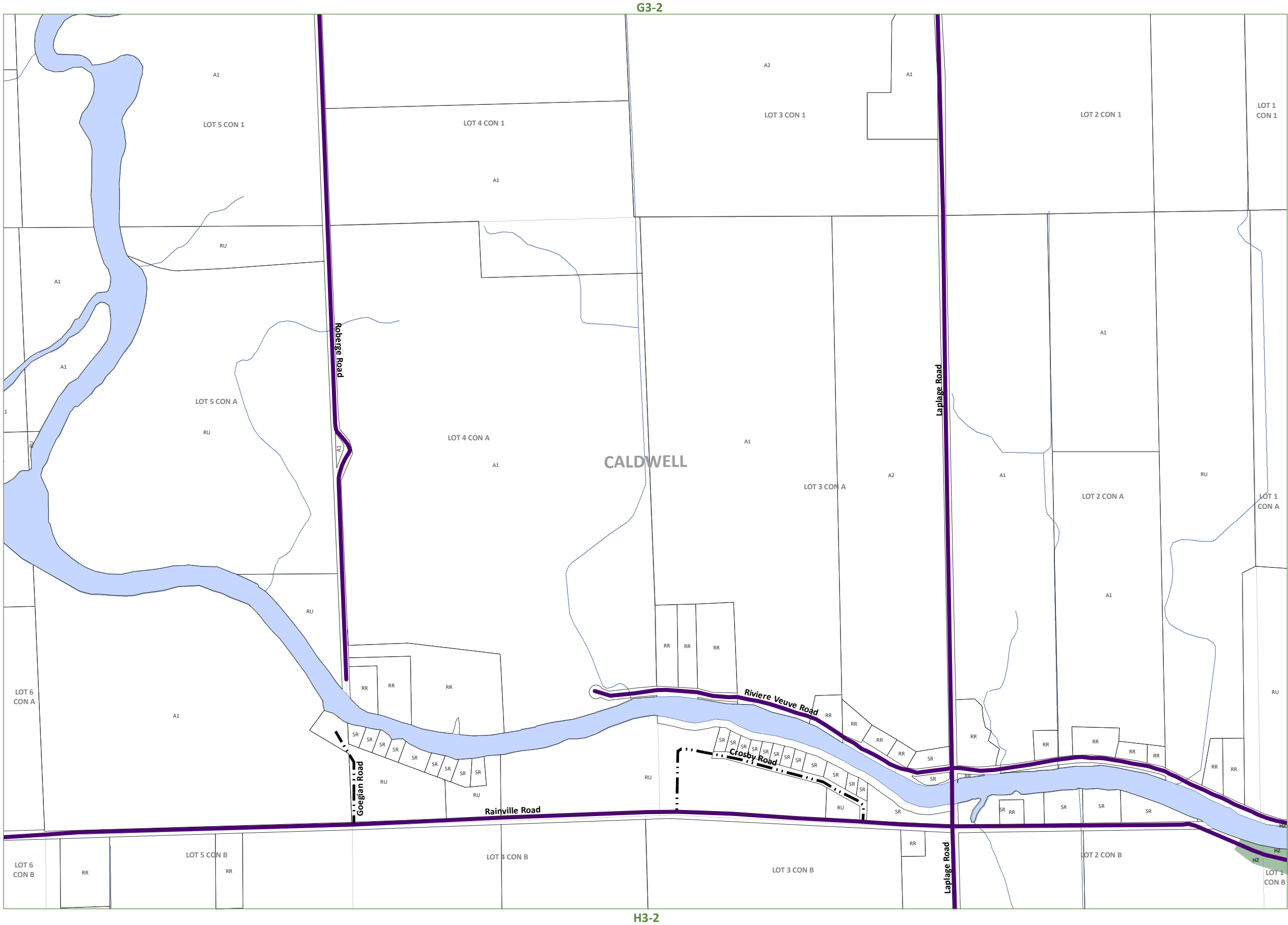

- |                                      |                           |
|--------------------------------------|---------------------------|
| A1 Agriculture One                   | RU Rural                  |
| A2 Agriculture Two                   |                           |
| R1 Residential One                   | R2 Residential Two        |
| R3 Residential Three                 | R4 Residential Four       |
| SR Shoreline Residential             |                           |
| RR Rural Residential                 |                           |
| MHR Mobile Home Residential          |                           |
| C1 General Commercial                | C2 Highway Commercial     |
| C3 Tourist Commercial                |                           |
| M1 Light Industrial                  | M2 Heavy Industrial       |
| M3 Extractive Industrial             | Waste Disposal Industrial |
| CL Crown Land                        | OS Open Space             |
| CF Community Facility                |                           |
| PSW Provincially Significant Wetland |                           |
| HZ Hazard Lands                      |                           |
| Waste Management Influence Area      |                           |
| Settlement Areas                     |                           |
| Former Municipal Boundaries          |                           |
| Highways                             | Private Roads             |
| Township Roads                       | Resource Roads            |
| Pipeline                             | Rail Lines                |

1 : 10,000 Metres

This map is for illustration purposes only. The information displayed on this map has been created from Ministry of Natural Resources, Ontario Base Mapping & MPAC Property Fabrics. While every effort has been made to accurately depict the information, this map should not be relied on as a precise indicator of locations of features or roads.

Base Mapping Source:  
Ministry of Natural Resources - Ontario Base Mapping  
MPAC - Municipal Property Assessment Corporation

**PLANScape**  
BUILDING COMMUNITY THROUGH PLANNING

Adopted July 8, 2014



WEST NIPISSING OUEST  
ZONING BY-LAW 2014-45

CONSOLIDATION  
JUNE 1, 2018

Schedule G4-3  
CALDWELL/SPRINGER

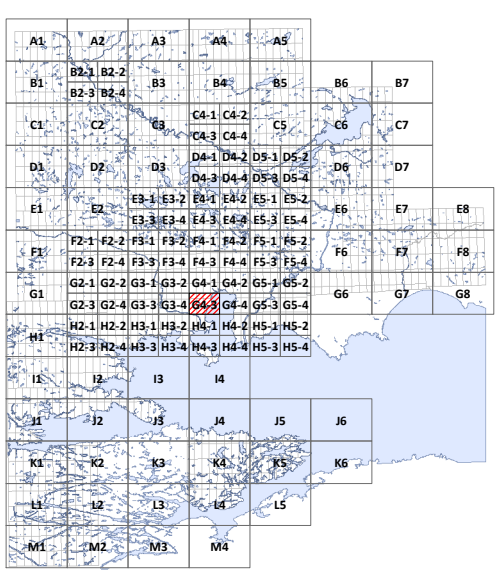
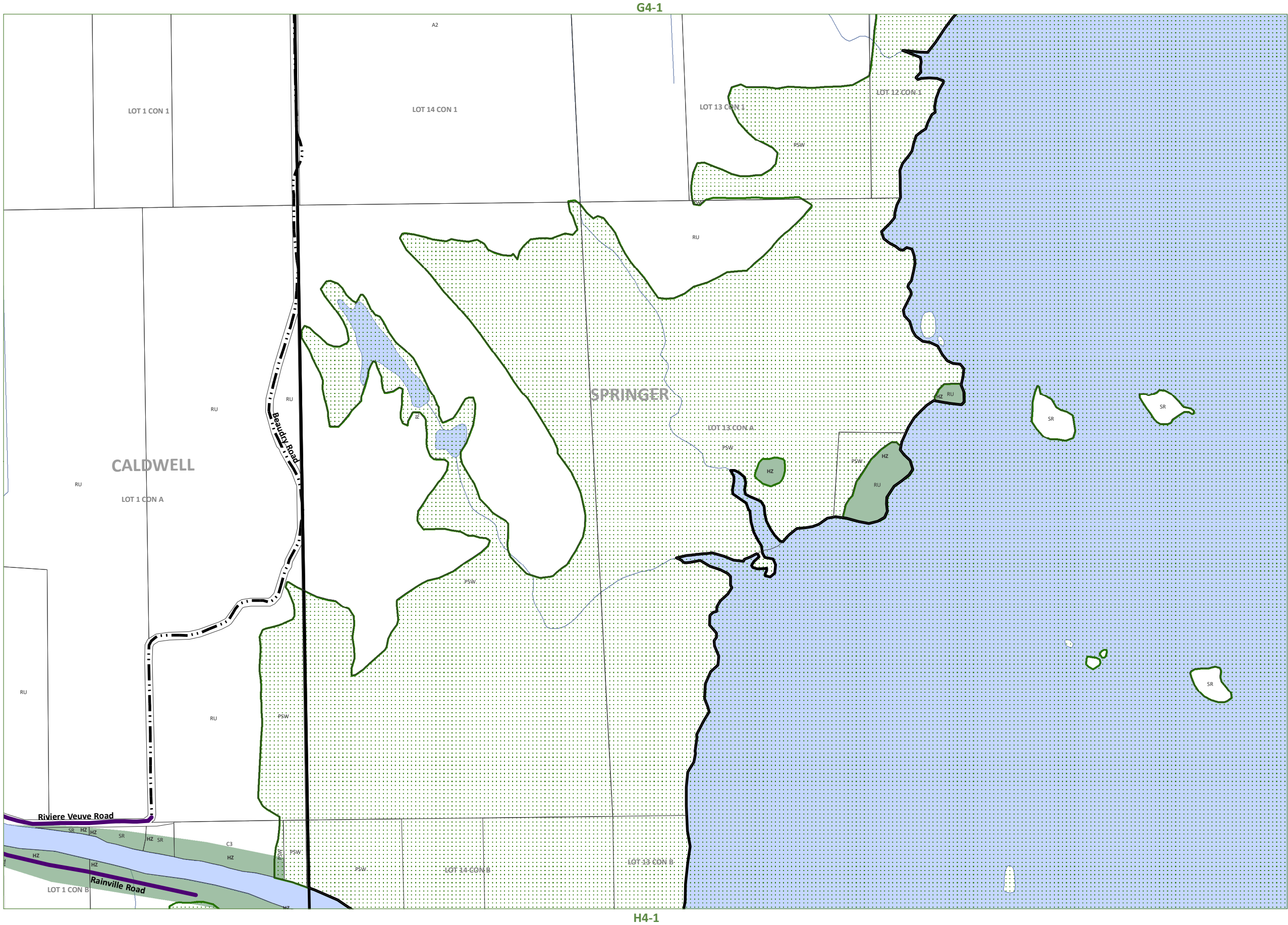

A1	Agriculture One	RU	Rural
A2	Agriculture Two		
R1	Residential One	R2	Residential Two
R3	Residential Three	R4	Residential Four
SR	Shoreline Residential		
RR	Rural Residential		
MHR	Mobile Home Residential		
C1	General Commercial	C2	Highway Commercial
C3	Tourist Commercial		
M1	Light Industrial	M2	Heavy Industrial
M3	Extractive Industrial		Waste Disposal Industrial
CL	Crown Land	OS	Open Space
CF	Community Facility		
PSW	Provincially Significant Wetland		
HZ	Hazard Lands		
	Waste Management Influence Area		
	Settlement Areas		
	Former Municipal Boundaries		
	Highways		Private Roads
	Township Roads		Resource Roads
	Pipeline		Rail Lines

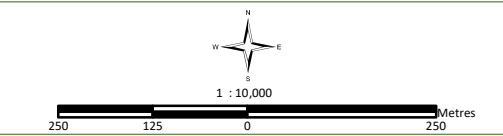

This map is for illustration purposes only. The information displayed on this map has been created from Ministry of Natural Resources, Ontario Base Mapping & MPAC Property Fabrics. While every effort has been made to accurately depict the information, this map should not be relied on as a precise indicator of locations of features or roads.

Base Mapping Source:  
Ministry of Natural Resources - Ontario Base Mapping  
MPAC - Municipal Property Assessment Corporation

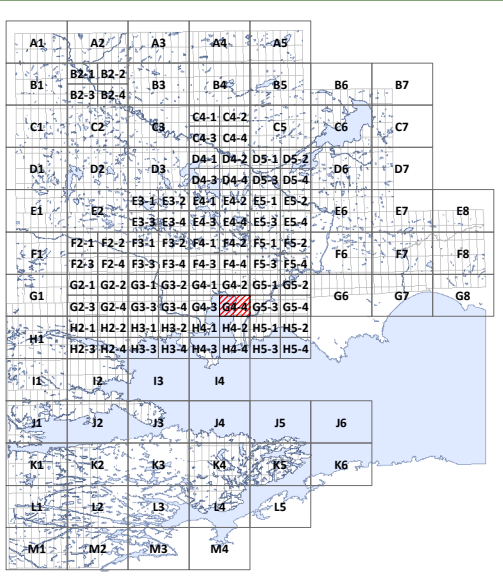
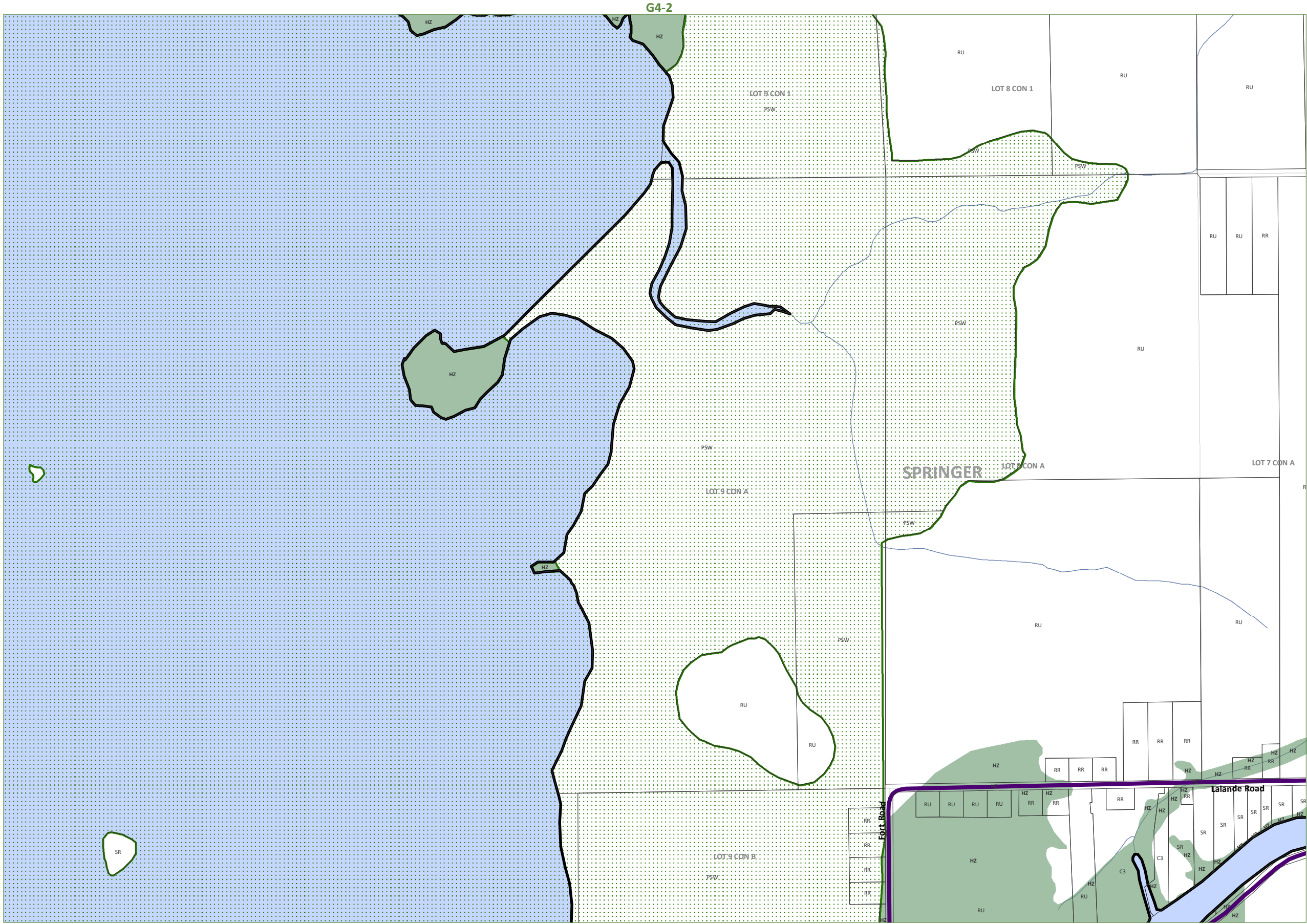

A1	Agriculture One	RU	Rural
A2	Agriculture Two		
R1	Residential One	R2	Residential Two
R3	Residential Three	R4	Residential Four
SR	Shoreline Residential		
RR	Rural Residential		
MHR	Mobile Home Residential		
C1	General Commercial	C2	Highway Commercial
C3	Tourist Commercial		
M1	Light Industrial	M2	Heavy Industrial
M3	Extractive Industrial		Waste Disposal Industrial
CL	Crown Land	OS	Open Space
CF	Community Facility		
PSW	Provincially Significant Wetland		

- HZ Hazard Lands
- Waste Management Influence Area
- Settlement Areas
- Former Municipal Boundaries
- Highways
- Township Roads
- Pipeline
- Private Roads
- Resource Roads
- Rail Lines

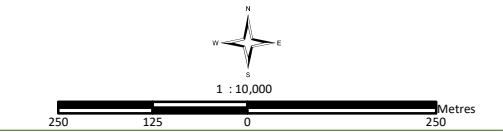

This map is for illustration purposes only. The information displayed on this map has been created from Ministry of Natural Resources, Ontario Base Mapping & MPAC Property Fabrics. While every effort has been made to accurately depict the information, this map should not be relied on as a precise indicator of locations of features or roads.

Base Mapping Source:  
Ministry of Natural Resources - Ontario Base Mapping  
MPAC - Municipal Property Assessment Corporation





# WEST NIPISSING OUEST

## ZONING BY-LAW 2014-45

CONSOLIDATION  
JUNE 1, 2018

# Schedule G5-3

SPRINGER

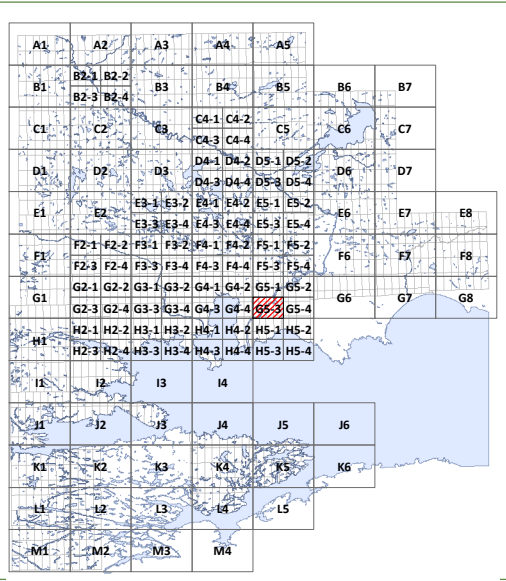
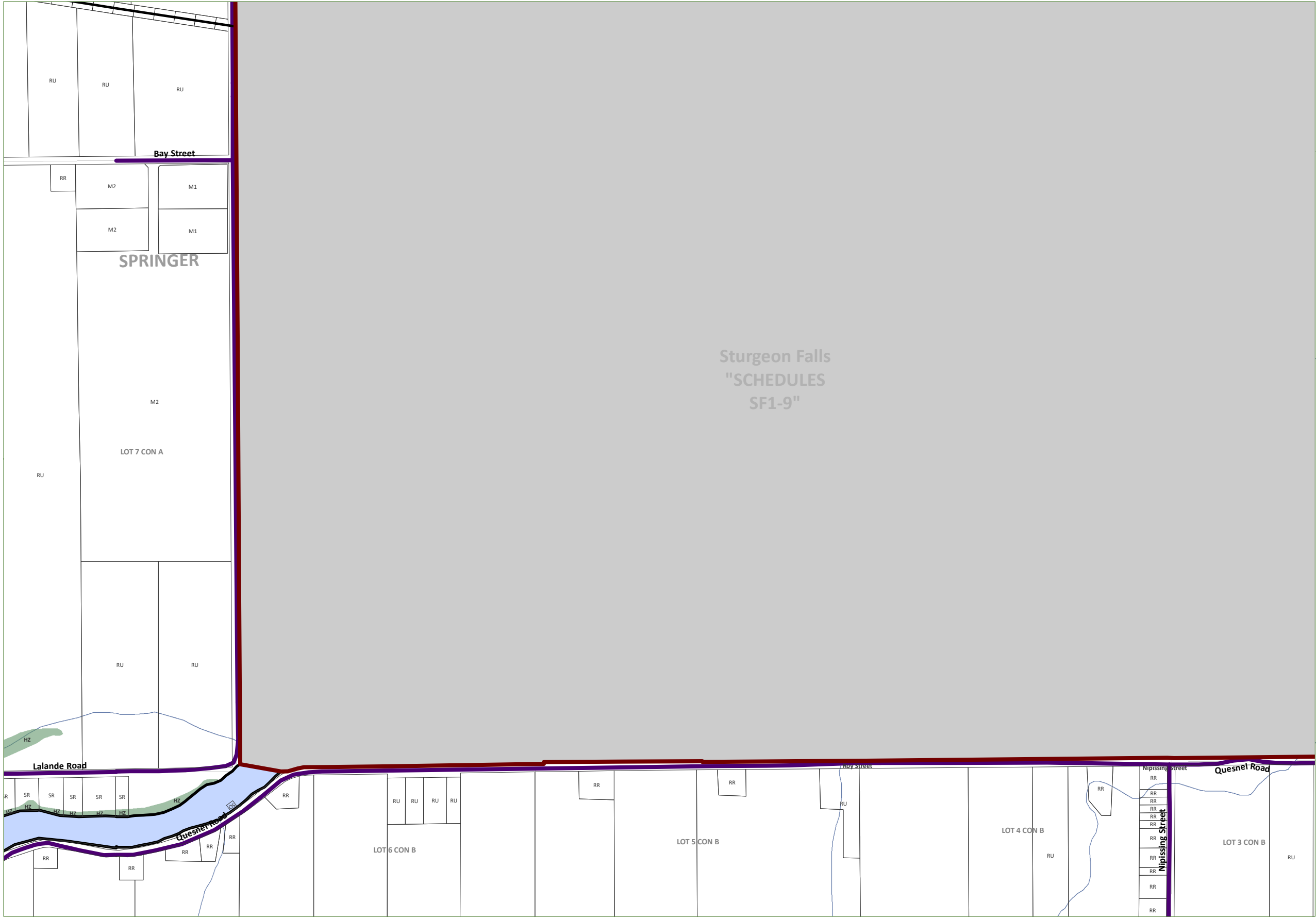

A1	Agriculture One	RU	Rural
A2	Agriculture Two		
R1	Residential One	R2	Residential Two
R3	Residential Three	R4	Residential Four
SR	Shoreline Residential		
RR	Rural Residential		
MHR	Mobile Home Residential		
C1	General Commercial	C2	Highway Commercial
C3	Tourist Commercial		
M1	Light Industrial	M2	Heavy Industrial
M3	Extractive Industrial		Waste Disposal Industrial
CL	Crown Land	OS	Open Space
CF	Community Facility		
PSW	Provincially Significant Wetland		
HZ	Hazard Lands		
	Waste Management Influence Area		
	Settlement Areas		
	Former Municipal Boundaries		
	Highways		Private Roads
	Township Roads		Resource Roads
	Pipeline		Rail Lines

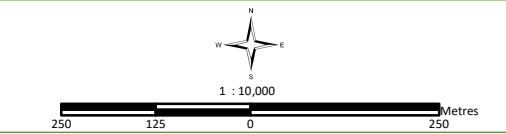

This map is for illustration purposes only. The information displayed on this map has been created from Ministry of Natural Resources, Ontario Base Mapping & MPAC Property Fabrics. While every effort has been made to accurately depict the information, this map should not be relied on as a precise indicator of locations of features or roads.

Base Mapping Source:  
Ministry of Natural Resources - Ontario Base Mapping  
MPAC - Municipal Property Assessment Corporation



# CONSOLIDATION



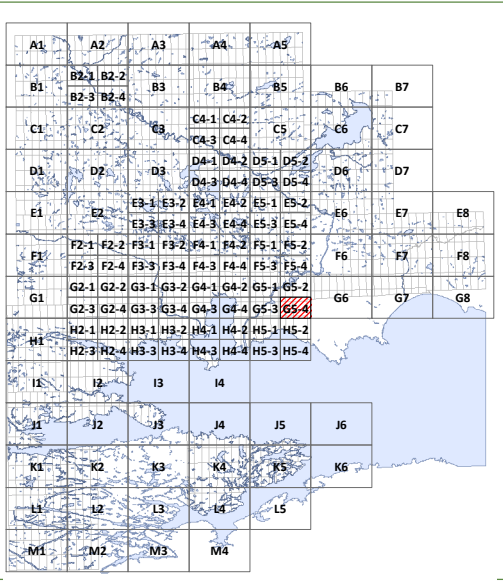

## JUNE 1, 2018

# Schedule G5-4

SPRINGER/PEDLEY



A1	Agriculture One	RU	Rural
A2	Agriculture Two		
R1	Residential One	R2	Residential Two
R3	Residential Three	R4	Residential Four
SR	Shoreline Residential		
RR	Rural Residential		
MHR	Mobile Home Residential		
C1	General Commercial	C2	Highway Commercial
C3	Tourist Commercial		
M1	Light Industrial	M2	Heavy Industrial
M3	Extractive Industrial		Waste Disposal Industrial
CL	Crown Land	OS	Open Space
CF	Community Facility		
PSW	Provincially Significant Wetland		

 Hazard Lands  
 Waste Management Influence Area  
 Settlement Areas  
 Former Municipal Boundaries

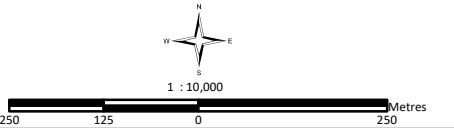

This map is for illustration purposes only. The information displayed on this map has been created from Ministry of Natural Resources, Ontario Base Mapping & MPAC Property Fabrics. While every effort has been made to accurately depict the information, this map should not be relied on as a precise indicator of locations of features or roads.

Base Mapping Source:  
Ministry of Natural Resources - Ontario Base Mapping  
MPAC - Municipal Property Assessment Corporation



**Adopted July 8, 2014**



# WEST NIPISSING OUEST

## ZONING BY-LAW 2014-45

CONSOLIDATION  
JUNE 1, 2018

# Schedule G6

PEDLEY

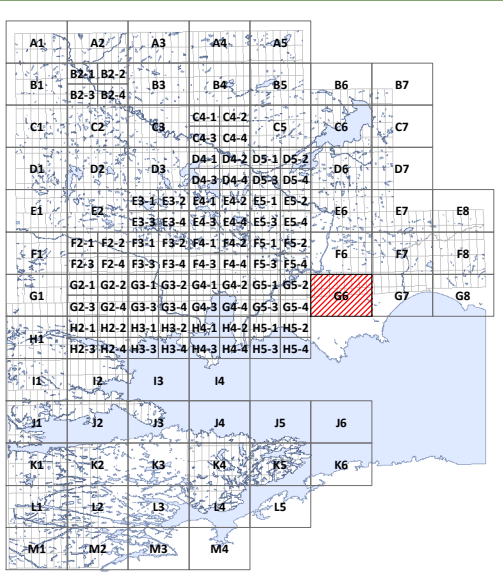

A1	Agriculture One	RU	Rural
A2	Agriculture Two		
R1	Residential One	R2	Residential Two
R3	Residential Three	R4	Residential Four
SR	Shoreline Residential		
RR	Rural Residential		
MHR	Mobile Home Residential		
C1	General Commercial	C2	Highway Commercial
C3	Tourist Commercial		
M1	Light Industrial	M2	Heavy Industrial
M3	Extractive Industrial		Waste Disposal Industrial
CL	Crown Land	OS	Open Space
CF	Community Facility		
PSW	Provincially Significant Wetland		
HZ	Hazard Lands		
	Waste Management Influence Area		
	Settlement Areas		
	Former Municipal Boundaries		
	Highways		Private Roads
	Township Roads		Resource Roads
	Pipeline		Rail Lines

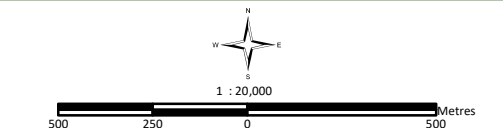

This map is for illustration purposes only. The information displayed on this map has been created from Ministry of Natural Resources, Ontario Base Mapping & MPAC Property Fabrics. While every effort has been made to accurately depict the information, this map should not be relied on as a precise indicator of locations of features or roads.

Base Mapping Source:  
Ministry of Natural Resources - Ontario Base Mapping  
MPAC - Municipal Property Assessment Corporation



# CONSOLIDATION

## JUNE 1, 2018

# Schedule G7

**BEAUCAGE/PEDLEY**

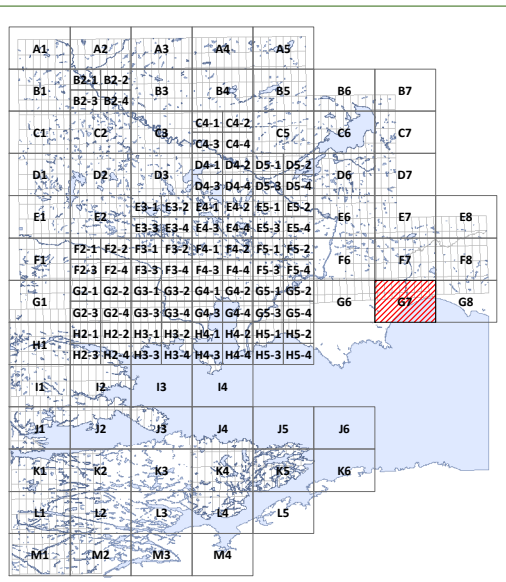
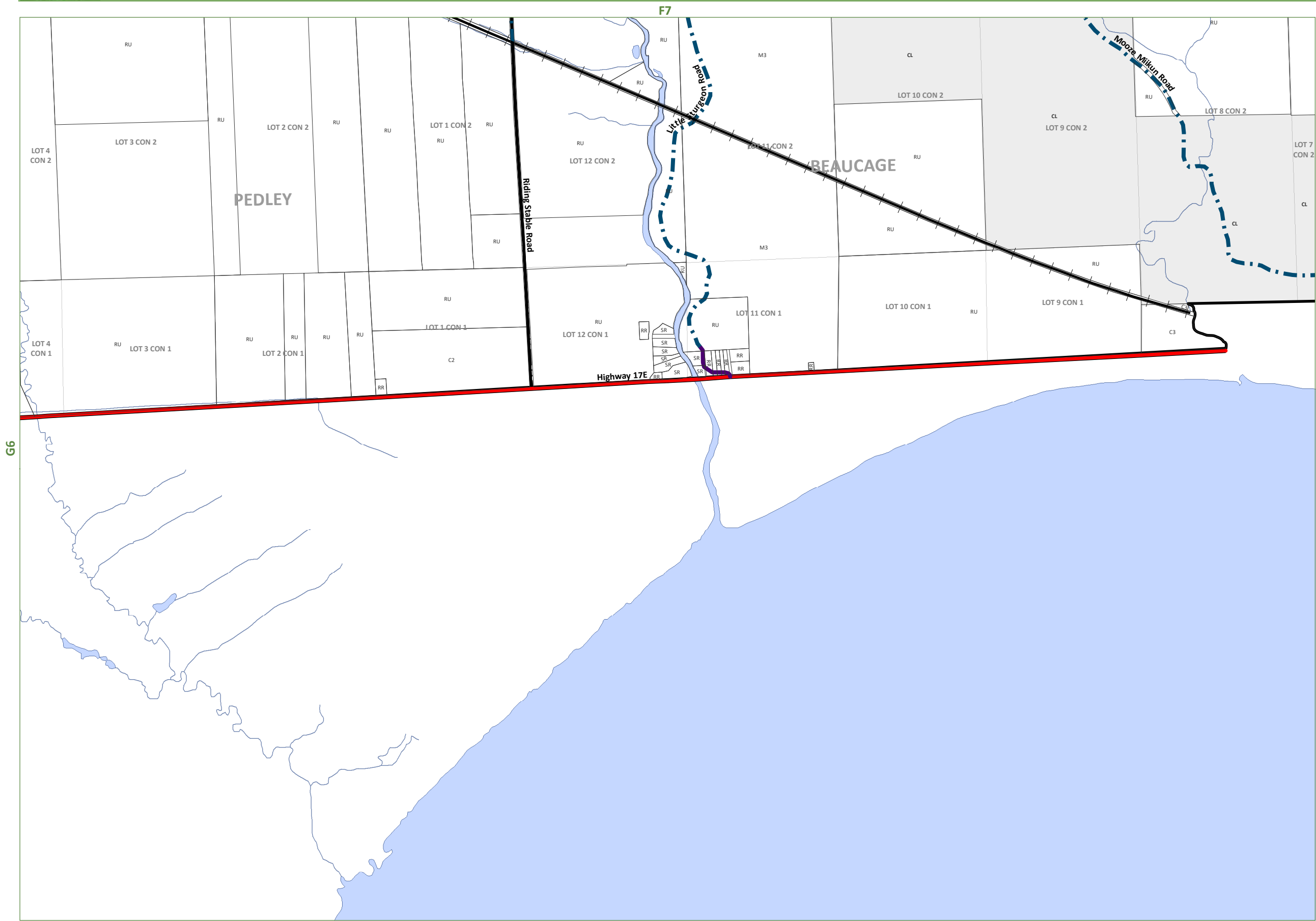

A1	Agriculture One	RU	Rural
A2	Agriculture Two		
R1	Residential One	R2	Residential Two
R3	Residential Three	R4	Residential Four
SR	Shoreline Residential		
RR	Rural Residential		
MHR	Mobile Home Residential		
C1	General Commercial	C2	Highway Commercial
C3	Tourist Commercial		
M1	Light Industrial	M2	Heavy Industrial
M3	Extractive Industrial		Waste Disposal Industrial
CL	Crown Land	OS	Open Space
CF	Community Facility		
PSW	Provincially Significant Wetland		

 Hazard Lands  
 Waste Management Influence Area  
 Settlement Areas  
 Former Municipal Boundaries

 Highways       Private Roads  
 Township Roads       Resource Roads  
 Pipeline       Rail Lines

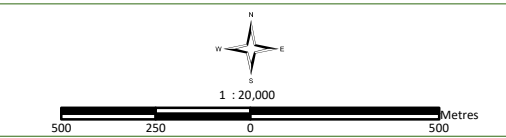

This map is for illustration purposes only. The information displayed on this map has been created from Ministry of Natural Resources, Ontario Base Mapping & MPAC Property Fabric. While every effort has been made to accurately depict the information, this map should not be relied on as a precise indicator of locations of features or roads.

Base Mapping Source:  
Ministry of Natural Resources - Ontario Base Mapping  
MPAC - Municipal Property Assessment Corporation



**Adopted July 8, 2014**





# WEST NIPISSING OUEST

## ZONING BY-LAW 2014-45

CONSOLIDATION  
JUNE 1, 2018

# Schedule G8

BEAUCAGE

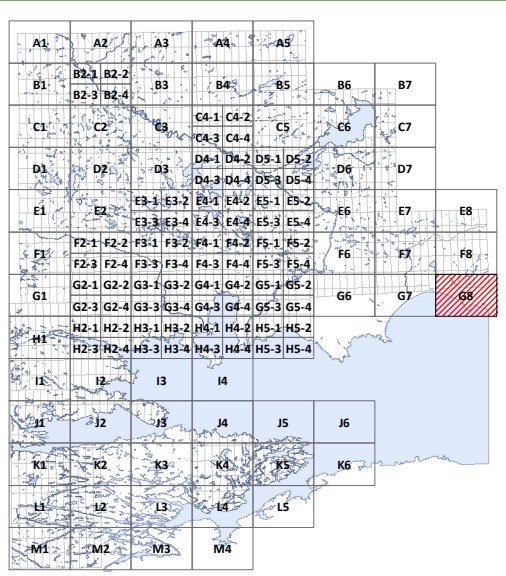

A1	Agriculture One	RU	Rural
A2	Agriculture Two		
R1	Residential One	R2	Residential Two
R3	Residential Three	R4	Residential Four
SR	Shoreline Residential		
RR	Rural Residential		
MHR	Mobile Home Residential		
C1	General Commercial	C2	Highway Commercial
C3	Tourist Commercial		
M1	Light Industrial	M2	Heavy Industrial
M3	Extractive Industrial		Waste Disposal Industrial
CL	Crown Land	OS	Open Space
CF	Community Facility		
PSW	Provincially Significant Wetland		
HZ	Hazard Lands		
	Waste Management Influence Area		
	Settlement Areas		
	Former Municipal Boundaries		
	Highways		Private Roads
	Township Roads		Resource Roads
	Pipeline		Rail Lines

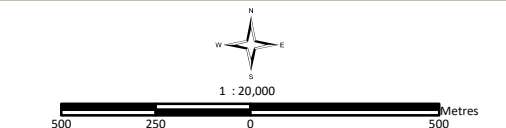

This map is for illustration purposes only. The information displayed on this map has been created from Ministry of Natural Resources, Ontario Base Mapping & MPAC Property Fabrics. While every effort has been made to accurately depict the information, this map should not be relied on as a precise indicator of locations of features or roads.

Base Mapping Source:  
Ministry of Natural Resources - Ontario Base Mapping  
MPAC - Municipal Property Assessment Corporation



WEST NIPISSING OUEST  
ZONING BY-LAW 2014-45

CONSOLIDATION  
JUNE 1, 2018

Schedule H1  
MACPHERSON

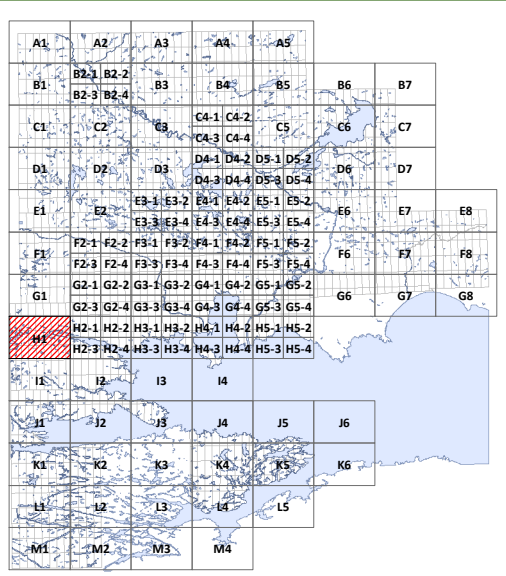
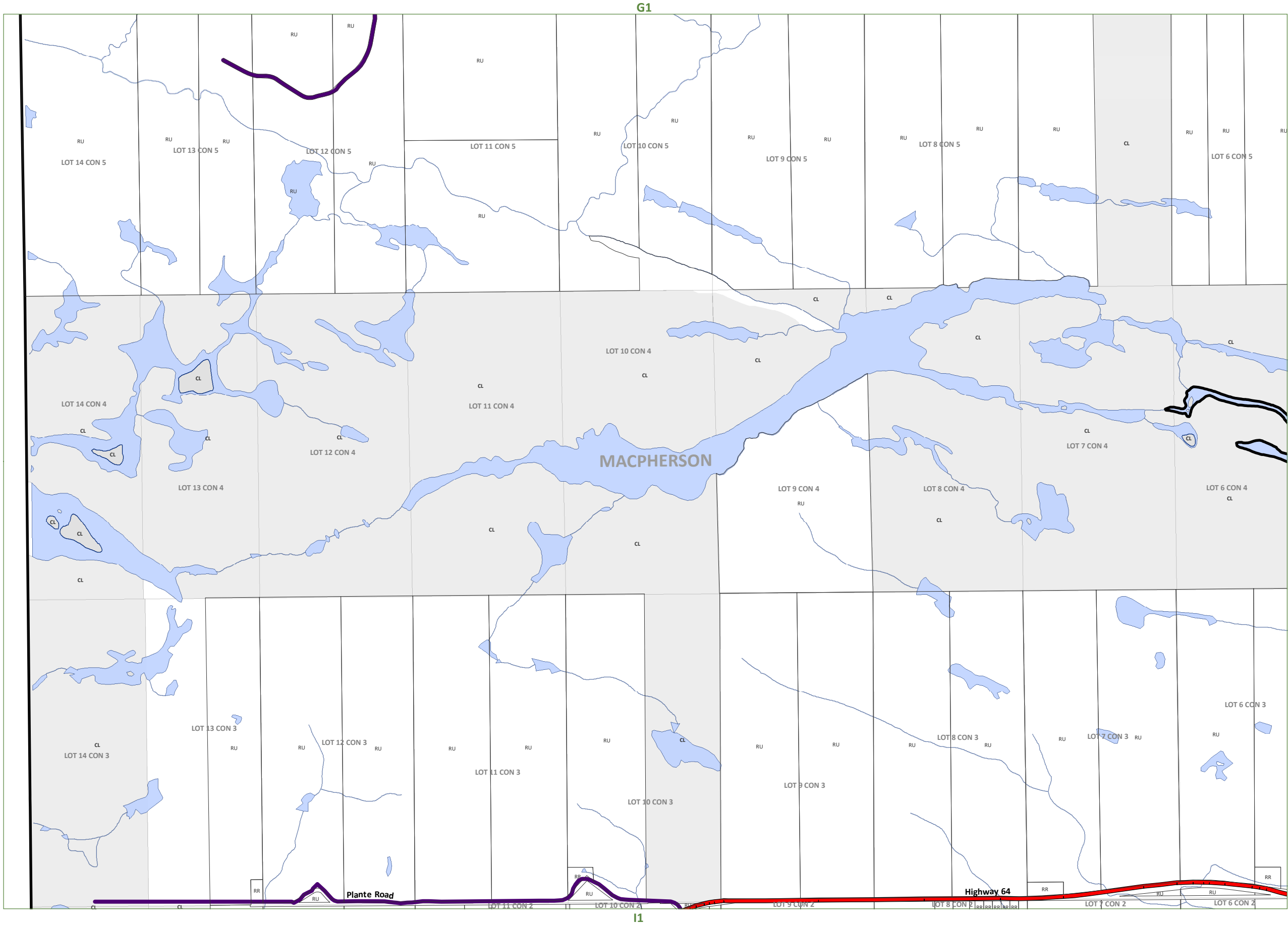

A1	Agriculture One	RU	Rural
A2	Agriculture Two		
R1	Residential One	R2	Residential Two
R3	Residential Three	R4	Residential Four
SR	Shoreline Residential		
RR	Rural Residential		
MHR	Mobile Home Residential		
C1	General Commercial	C2	Highway Commercial
C3	Tourist Commercial		
M1	Light Industrial	M2	Heavy Industrial
M3	Extractive Industrial		Waste Disposal Industrial
CL	Crown Land	OS	Open Space
CF	Community Facility		
PSW	Provincially Significant Wetland		
HZ	Hazard Lands		
WMA	Waste Management Influence Area		
SA	Settlement Areas		
FMB	Former Municipal Boundaries		
Highways	Private Roads		
Township Roads	Resource Roads		
Pipeline	Rail Lines		

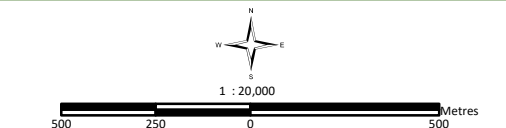

This map is for illustration purposes only. The information displayed on this map has been created from Ministry of Natural Resources, Ontario Base Mapping & MPAC Property Fabrics. While every effort has been made to accurately depict the information, this map should not be relied on as a precise indicator of locations of features or roads.

Base Mapping Source:  
Ministry of Natural Resources - Ontario Base Mapping  
MPAC - Municipal Property Assessment Corporation



# CONSOLIDATION

## JUNE 1, 2018

# Schedule H2-1

**MACPHERSON**

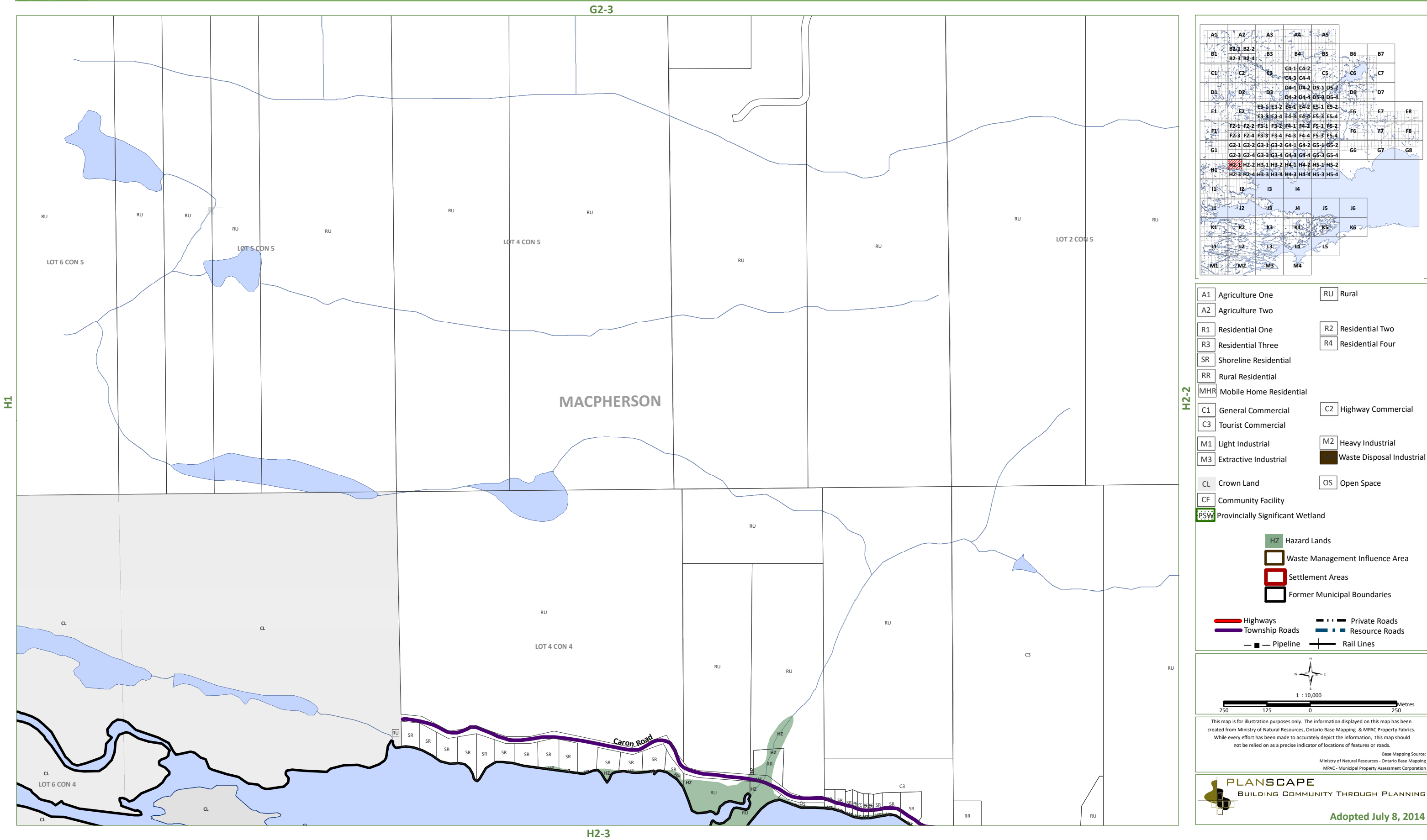



# WEST NIPISSING OUEST ZONING BY-LAW 2014-45

CONSOLIDATION  
JUNE 1, 2018

## Schedule H2-2 MACPHERSON/CALDWELL

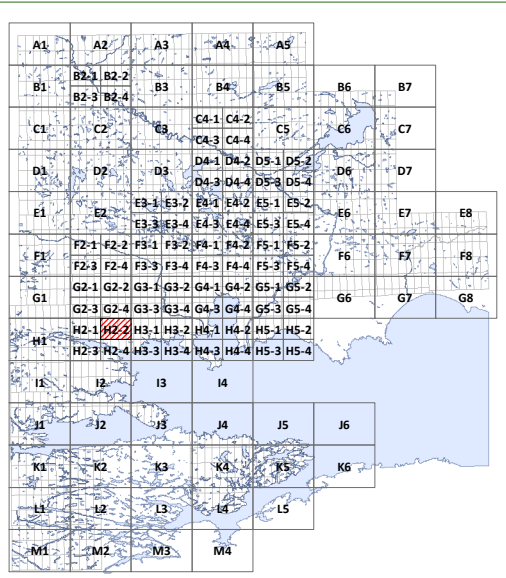
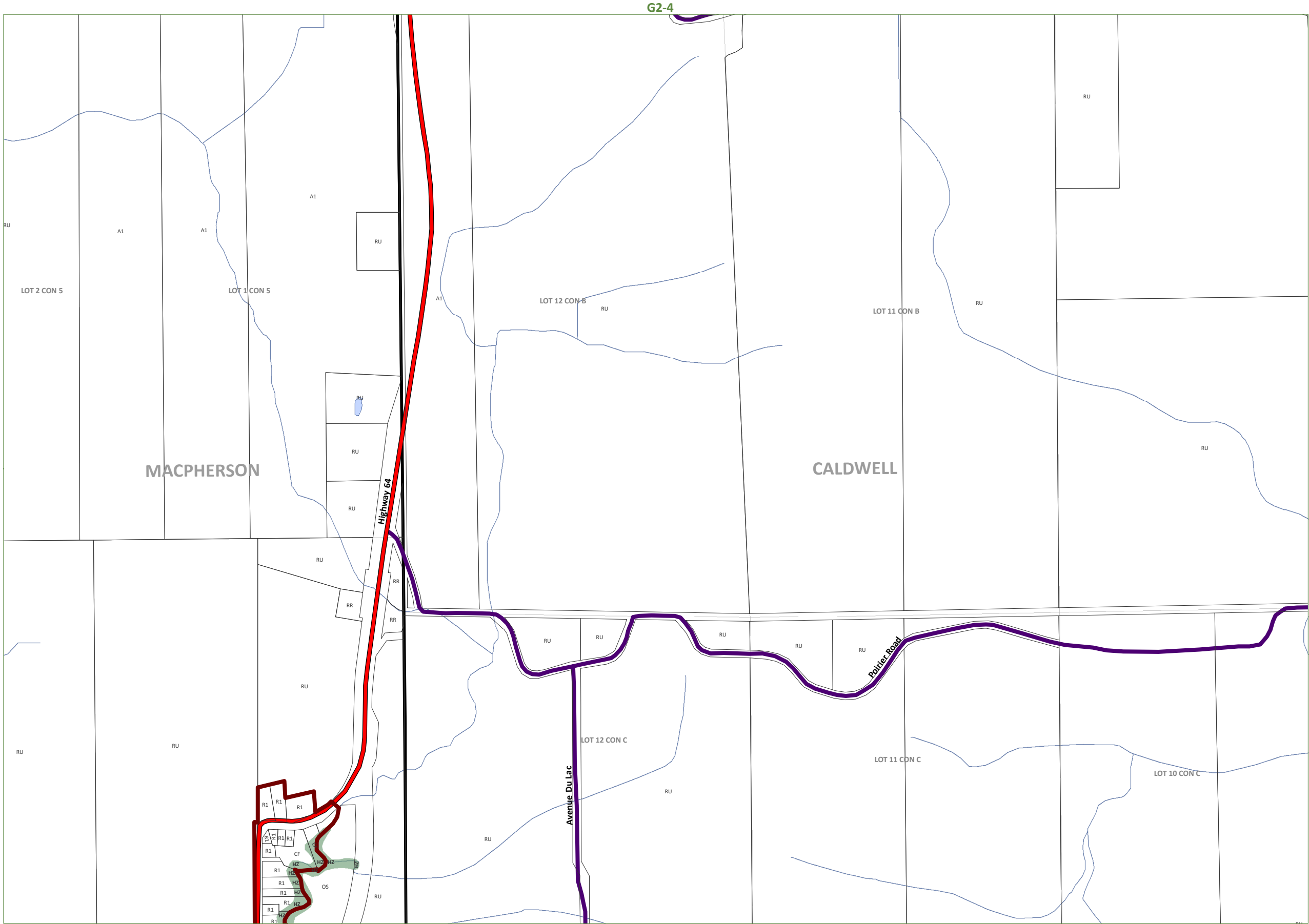

A1	Agriculture One	RU	Rural
A2	Agriculture Two		
R1	Residential One	R2	Residential Two
R3	Residential Three	R4	Residential Four
SR	Shoreline Residential		
RR	Rural Residential		
MHR	Mobile Home Residential		
C1	General Commercial	C2	Highway Commercial
C3	Tourist Commercial		
M1	Light Industrial	M2	Heavy Industrial
M3	Extractive Industrial		Waste Disposal Industrial
CL	Crown Land	OS	Open Space
CF	Community Facility		
PSW	Provincially Significant Wetland		

HZ	Hazard Lands
	Waste Management Influence Area
	Settlement Areas
	Former Municipal Boundaries
	Highways
	Township Roads
	Pipeline
	Private Roads
	Resource Roads
	Rail Lines

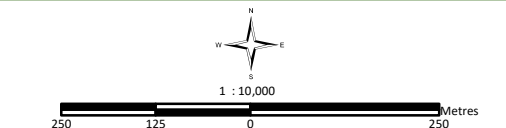

This map is for illustration purposes only. The information displayed on this map has been created from Ministry of Natural Resources, Ontario Base Mapping & MPAC Property Fabrics. While every effort has been made to accurately depict the information, this map should not be relied on as a precise indicator of locations of features or roads.

Base Mapping Source:  
Ministry of Natural Resources - Ontario Base Mapping  
MPAC - Municipal Property Assessment Corporation